

2014 DINNER WITH A DAWG LAYOUT

February 25, 2013

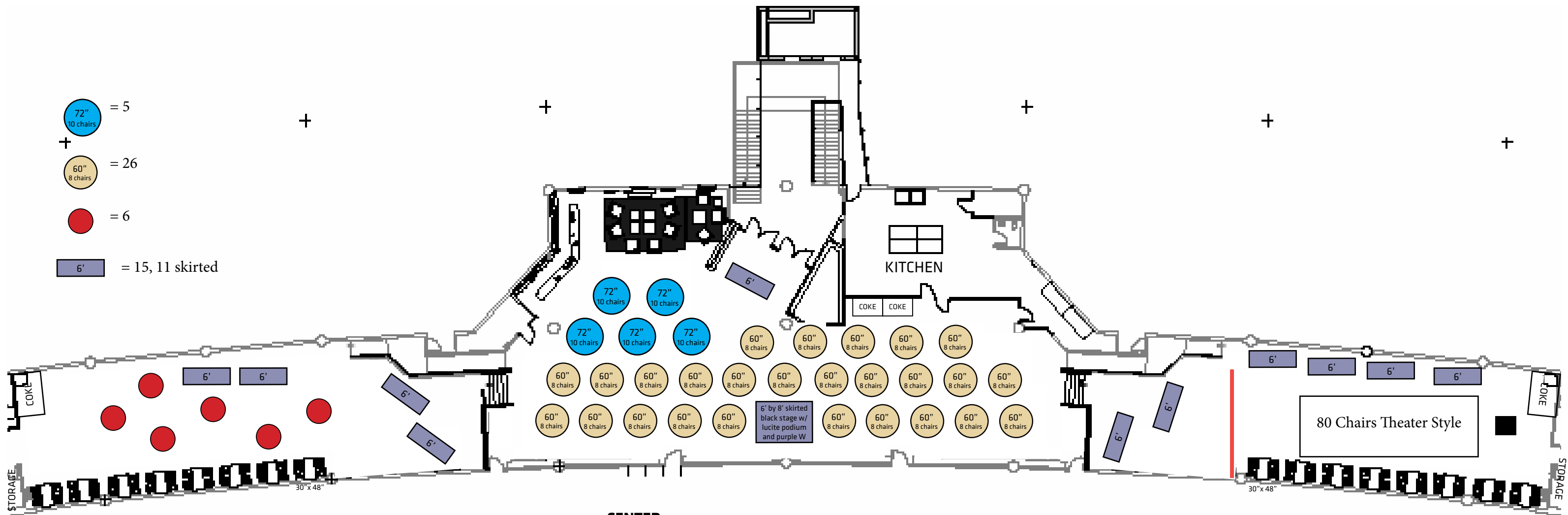

WEST

- 6' Rectangles (skirted) = 4 (two at top of west stairs, two on the wall)
- Cocktail Tables = 6

CENTER

- 72" rounds = 5 (10 chairs Each)
 - 60" Rounds = 26 (8 chairs ach)
 - Chairs = 270 (10 or eight per table with extra in the Closet)
 - 6' Rectangle (skirted) = One at entrance
 - 6'x8' stage - skirted with carpet and lucite podium
- Other:
- Cover Coke fridges with black Drape
 - 6' rectangles (skirted) = 2 at base of north elevators
 - 6' rectangles (skirted) = 2 at Dawg Pack west entrance

EAST

- 6' Rectangles (skirted) =2 at top of east stairs
- 6' Rectangles (unskirted) =Line the North Wall as you see fit
- Wood Podium
- Chairs = 80 theater style, set up as you see fit
- Other: Pipe and Drape off the East Side as shown in red